

CHEM NM-3

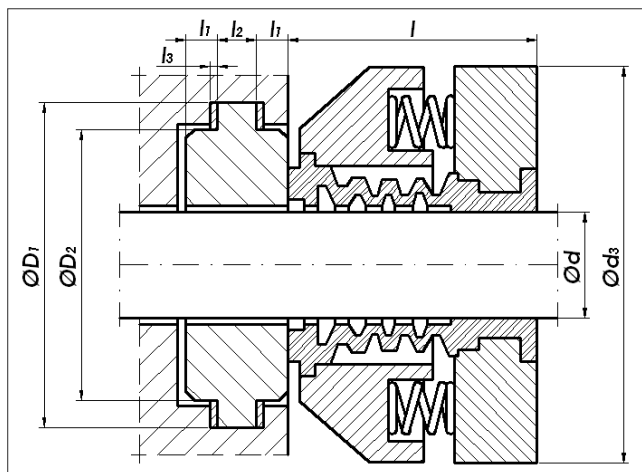

d	D₁	D₂	d₃	l	l₁	l₂	l₃
16	49	38,0	54	32	5,0	8,0	1,0
18	49	38,0	54	32	5,0	8,0	1,0
20	52	41,0	57	32	5,0	8,0	1,0
22	52	41,0	57	32	5,0	8,0	1,0
24	55	44,0	61	34	5,0	8,0	1,0
25	55	44,0	61	34	5,0	8,0	1,0
28	66	52,0	67	37	8,0	11,0	1,5
30	69	55,0	70	38	8,0	11,0	1,5
32	69	55,0	70	38	8,0	11,0	1,5
33	72	58,0	73	39	8,0	11,0	1,5
35	72	58,0	73	39	8,0	11,0	1,5
38	79	65,0	76	39	8,0	11,0	1,5
40	82	68,0	80	41	8,0	11,0	1,5
43	85	71,0	83	41	8,0	11,0	1,5
45	85	71,0	83	41	8,0	11,0	1,5
48	98	80,0	89	44	10,0	14,0	1,5
50	98	80,0	89	44	10,0	14,0	1,5
53	101	84,0	103	54	10,0	14,0	1,5
55	104	87,0	107	54	10,0	14,0	1,5
58	106	90,0	110	54	10,0	14,0	1,5
60	106	90,0	110	54	10,0	14,0	1,5
63	111	93,0	113	54	10,0	14,0	1,5
65	114	96,0	116	54	10,0	14,0	1,5
68	117	99,0	118	54	10,0	14,0	1,5
70	117	99,0	118	54	10,0	14,0	1,5
75	122	104,0	126	54	10,0	14,0	1,5
80	133	115,0	150	74	10,0	14,0	1,5
85	139	122,0	156	74	10,0	14,0	1,5
90	145	128,0	163	74	10,0	14,0	1,5
95	145	128,0	163	74	10,0	14,0	1,5
100	152	134,0	169	74	10,0	14,0	1,5
105	158	141,0	175	74	10,0	14,0	1,5
110	184	160,0	182	74	10,0	14,0	1,5
115	190	166,0	188	74	10,0	14,0	1,5
120	190	166,0	188	74	10,0	16,0	1,5
125	196	172,0	194	74	10,0	16,0	1,5
130	203	179,0	201	74	10,0	16,0	1,5
135	209	185,0	207	74	10,0	16,0	1,5
140	215	191,0	213	74	10,0	16,0	1,5
145	215	191,0	213	74	10,0	16,0	1,5
150	228	201,0	220	74	10,0	16,0	1,5
155	234	207,0	226	74	10,0	16,0	1,5
160	241	214,0	232	74	10,0	16,0	1,5
165	241	214,0	232	74	10,0	16,0	1,5



- _____ :
- _____ :
-
-
-
- _____ :
- (A, B)
- (Q1)
- (V)
- _____ :
- p = 8
- t = -40 ... 160 °C
- v = 10 /

+