

NM-2100

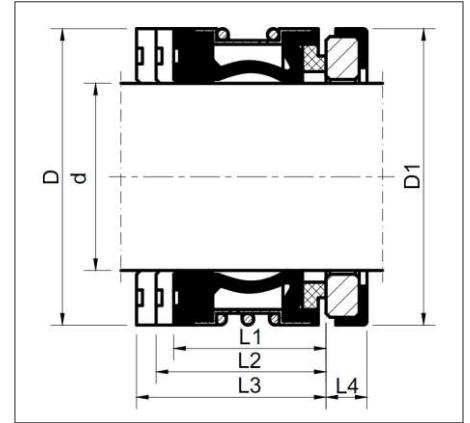

_____ :
 - _____ ()
 - _____ (A)
 - _____ (Q1, Q2)
 - _____ Al₂O₃ (V)

_____ :
 - _____, FKM (V)
 - _____ (P)
 - _____, EPDM (E)

_____ :
 - p=16
 - t=-20... 140°C
 - v=10 /

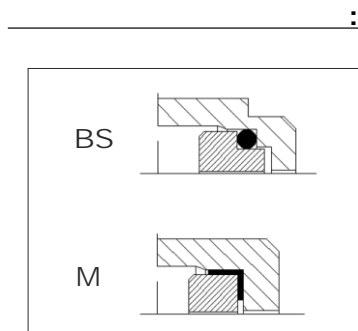

_____ :
 - **NM-2100S** (L1)
 - **NM-2100K** (L2)
 - **NM-2100** (L3)

d	D	D1	L4	L1	L2	L3
10	20	21	5	15.2	27.7	35.2
12	22	23	6	15.2	26.7	34.2
14	24	25	6	15.2	29.2	34.2
15	25	26	6	15.2	29.2	34.2
16	26	27	6	15.2	29.2	34.2
18	32	33	6	20.2	31.7	39.2
20	34	35	6	20.2	31.7	39.2
22	36	37	6	20.2	31.7	39.2
24	38	39	6	20.2	34.2	44.2
25	39	40	6	20.2	34.2	44.2
28	42	43	6	26.2	36.7	44.2
30	44	45	7	26.2	35.7	43.2
32	46	48	7	26.2	35.7	48.2
33	47	48	7	26.2	35.7	48.2
35	49	50	8	26.2	34.7	47.2
38	54	56	8	30.2	37.2	47.2
40	56	58	8	30.2	37.2	47.2
43	59	61	8	30.2	37.2	52.2
45	61	63	8	30.2	37.2	52.2
48	64	66	10	30.2	35.2	50.2
50	66	70	10	30.2	37.7	50.2
53	69	73	10	30.2	37.7	60.2
55	71	75	10	30.2	37.7	60.2
58	78	78	10	33.2	42.7	60.2
60	80	80	12	33.2	40.7	58.2
63	83	83	12	33.2	40.7	58.2
65	85	85	12	33.2	40.7	68.2
68	88	90	12	33.2	40.7	68.2
70	90	92	12	33.2	48.2	68.2
75	99	97	12	40.2	48.2	68.2
80	104	105	14	40.2	47.7	77.7
85	109	110	14	40.2	47.7	77.7
90	114	115	14	40.2	52.7	77.7
95	119	120	14	40.2	52.7	77.7
100	124	125	14	40.2	52.7	77.7